

# Heavy Duty Rod Seal

## Hardware Specifications

### Type: 135 Series

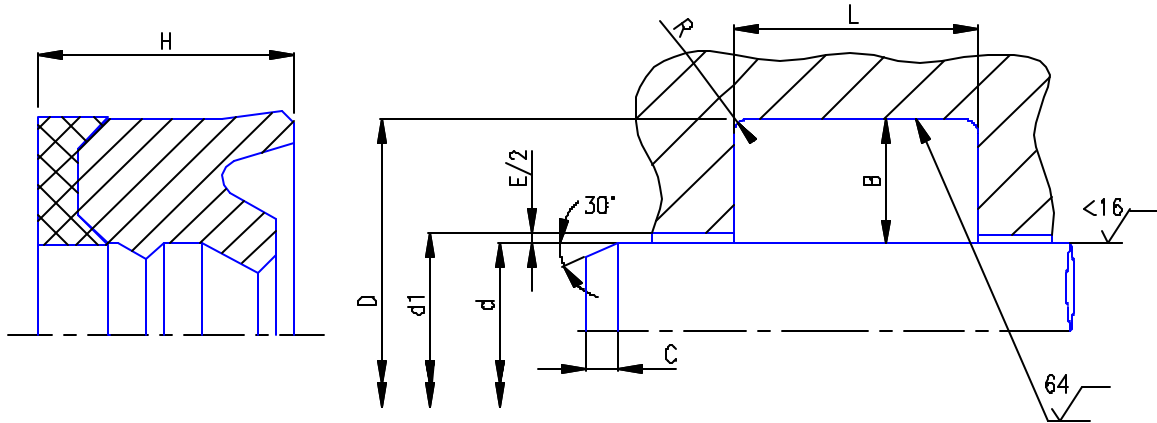

Note: 135 Series seal can be installed in open type housings to replace V-packing sets

	B	L	H	D	R typical	C
series 1	0.250	0.438	0.398	d + 0.500	0.008	0.195
series 2	0.313	0.500	0.455	d + 0.625	0.015	0.195
series 3	0.375	0.625	0.568	d + 0.750	0.015	0.250
series 4	0.500	0.875	0.795	d + 1.000	0.020	0.295
series 5	0.625	1.000	0.909	d + 1.250	0.040	0.295

Pressure	E
<1500 psi	0.020
<3600 psi	0.014
<6000 psi	0.009

Under certain conditions the extrusion gap can be increased, please consult our technical department.

Non-standard grooves can be supplied on request at no extra charge.

Material: Rhinthane P03/000

### Applications:

The 135 Series seal has been specifically designed for cylinders operating with fire safe fluids or for those which experience high side loading and deflection at high operating pressures or temperatures.

Typical applications include:

- Long Wall Cylinders
- Continuous Caster Cylinders
- Telescopic Cylinders

Pressure	6000psi ( 400 bar )	
Speed	1.65 ft/sec ( 5 m/s )	
Media - Temp compatibility	Min (F)	Max (F)
Hydraulic oil	-38	250
Water based Emulsions	40	140
Water Glycol	-38	140
Water	40	130
Polyol Ester	-38	150